

### Building Sketch

Client	Audrey Lehmann Richard				
Property Address	1502 Eva St				
City	Austin	County	Travis	State	TX
Appraiser	Slade Cooper	Zip Code	78704		

I'm not an architect, surveyor or engineer, and my measurements are based on the ANSI standards for measurement of square footage. Appraiser calculation of gross living area on 03/06/2025.

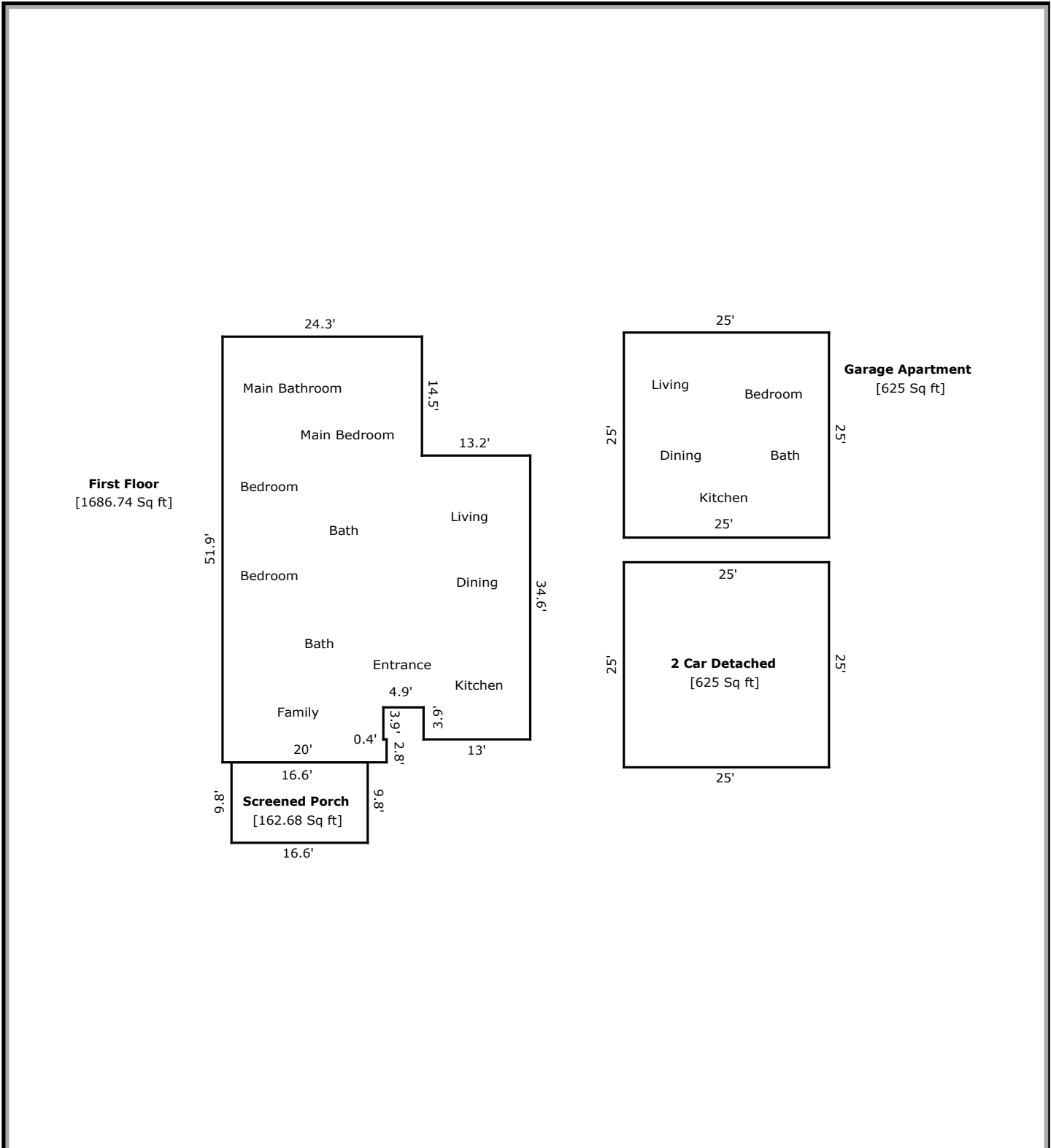

TOTAL Sketch by a la mode

#### Area Calculations Summary

Living Area		Calculation Details	
First Floor	1686.74 Sq ft	$24.3 \times 14.5 =$	352.35
		$37.5 \times 30.7 =$	1151.25
		$6.7 \times 19.6 =$	131.32
		$0.4 \times 2.8 =$	1.12
		$3.9 \times 13 =$	50.7
<b>Total Living Area (Rounded):</b>	<b>1687 Sq ft</b>		
Non-living Area			
Screened Porch	162.68 Sq ft	$9.8 \times 16.6 =$	162.68
2 Car Detached	625 Sq ft	$25 \times 25 =$	625
Garage Apartment	625 Sq ft	$25 \times 25 =$	625